

PRESSURE TRANSMITTER ASSEMBLY BPSG2-PTA-MOD-D

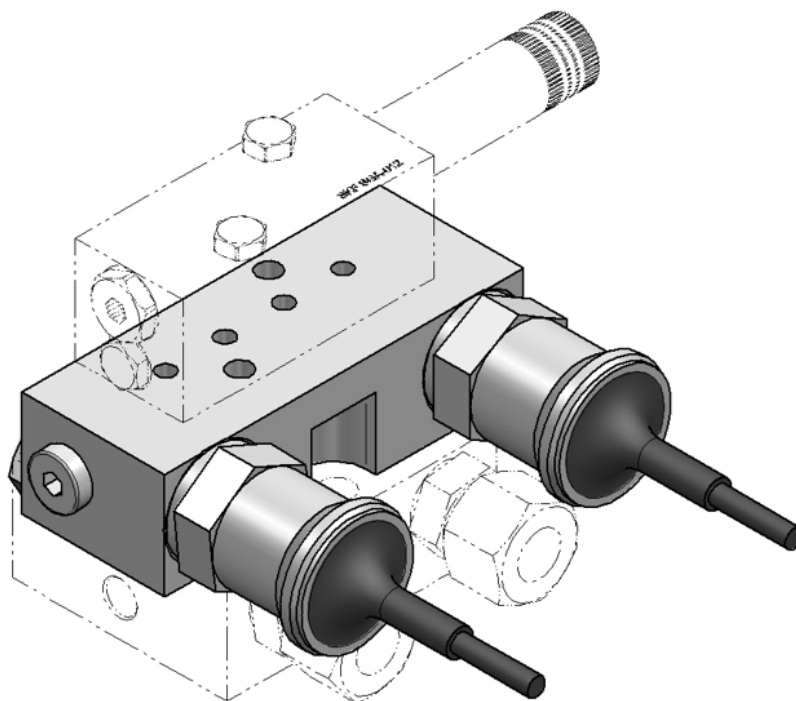

Date: **29.8.2023**

Document No: **PTA-MOD_EN**

Version: **2D**



Read this manual before
installing or commissioning the
product and keep it at hand for
later reference.



Read these operating instructions before installation and commissioning.

Only a professional is allowed to complete the installation and make electrical connections.
Failure to observe warnings or cautions - as well as non-compliance with the instructions - will result in loss of warranty claim or equipment liability.

Table of contents

Safety alerts, visual presentation, and layout.....	3	1.8 Storage	4
1. Safety instructions	3	2. General description	5
1.1 Intended use	3	3. Design	5
1.2 User's responsibilities.....	3	4. Operation	6
1.3 Delivery/receipt	4	5. Settings	6
1.4 Installation and operation	4	6. Technical specifications	6
1.5 Inspections, maintenance and cleaning	4	6.1 Technical specifications of pressure transmitter	6
1.6 Damaged equipment.....	4	6.2 Connections	6
1.7 Return consignments	4	6.3 Symbols	7
		7. Spare parts	8
		8. Appendices, China RoHS Table	9

Manufacturer

Oy SKF Ab
Teollisuustie 6 (PO Box 80)
40951 MUURAME
E-mail: skf-lube@skf.com
www.skf.com/lubrication
For more information about your local dealer, see SKF.com

Disclaimer

The manufacturer does not accept any liability for any damage caused by the following actions by the customer:

- Negligent or inappropriate use, assembly, operation, configuration, maintenance or repairs, or accidents;
- Improper or late response to malfunctions;
- Unauthorized modifications, negligence or wilful violation.
- The use of non-original (non-SKF) spare parts.

SKF's liability for damage resulting from the use of products is limited to the maximum purchase price. Liability for consequential damages of any kind is excluded.

Safety alerts, visual presentation, and layout

While reading these instructions, you will encounter various symbols, illustrations, and text layouts intended to help you navigate and understand the instructions.

Safety alerts:

Activities that present specific hazards (to life and limb or possible damage to property) are indicated with safety alerts. Always be sure to follow the instructions given in the safety alerts.

WARNING

These safety alerts indicate a direct and imminent danger. Ignoring them could result in death or serious injury.

WARNING

These safety alerts indicate a potential danger. Ignoring them could result in death or serious injury.

WARNING

These safety alerts indicate a potential danger. Ignoring them could result in minor injury.

CAUTION

These safety alerts indicate a potentially harmful situation. Ignoring them could result in damage to property or malfunctions.

NOTE

These notes indicate what should be taken into account in the various sections of the guide.

1. Safety instructions

1.1 Intended use

This product is only intended to be used as a component in a central lubrication system.

Use is only permitted within the scope of commercial or economic activity by professional users, in compliance with the specifications, technical data, and limits specified in this manual.

Unauthorized changes to the product are prohibited.

1.2 User's responsibilities

The product should only be used with awareness of the potential risks, in an appropriate technical condition and in accordance with the information in the operation instructions. It is the responsibility of the user to maintain and ensure the legibility of all safety/instruction signs.

These operation instructions must always be available to persons working with the product. Always read and follow the lubricant manufacturer's safety data sheet and recommendations for lubricant compatibility and the use of protective equipment. In addition to these instructions, the general statutory regulations on accident prevention and environmental protection must be observed.

1.3 Delivery/receipt

After receipt of the shipment, check the shipment for transport damage and completeness by comparing it to the shipping documents. Immediately report any damage suffered in transport to the forwarding agent. Keep the packaging material until any discrepancies are resolved.

⚠ WARNING



Always comply with the lifting and transport markings on the packaging to eliminate the risk of injury and damage.

1.4 Installation and operation

⚠ WARNING



Only start installing the product after you have read and fully understood the safety instructions and this manual.

Local safety regulations for installation, operation and maintenance must be observed.

- Keep unauthorized people away.
- Always use personal protective equipment.
Appropriate personal protective equipment must be worn to prevent lubricants from splashing onto the skin or into the eyes.
- Always disconnect the power source (electrical, pneumatic, or hydraulic) from the product during installation or when not in use and ensure that it cannot be accidentally switched on (lock and tag).
- Electrical work must be carried out only when the device is de-energized and using insulated tools suitable for electrical work.
- Only make connections according to the wiring diagrams.
- Only original SKF spare parts and SKF accessories may be used with the product.
- Check after installation, and before the first commissioning that all cables, connections and protective devices are properly secured.

1.5 Inspections, maintenance and cleaning

- Perform maintenance and inspections in accordance with the instructions provided in this manual. Note that maintenance intervals may be shorter in challenging applications.
- We recommend annual inspections by the nearest factory-authorized warranty and maintenance centre.

⚠ WARNING



When you clean electric devices, only use non-flammable detergents designed for electric components and take the device IP class into consideration.

1.6 Damaged equipment

⚠ WARNING



Do not use a device that appears to be damaged, severely worn, or operating abnormally!
Disable the device and contact SKF or an authorized dealer.

1.7 Return consignments

Before returning the product, all dirty parts must be cleaned. However, if this is not feasible or practical, for example, because it would prevent the detection of the defect in connection with a complaint, the transport company must be notified of the chemical used. On return consignments, at least the following information must be marked on the packaging:

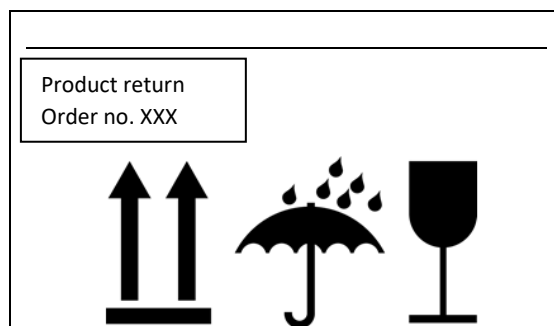

Marking of return consignments

1.8 Storage

SKF products are subject to the following storage conditions:

- Storage indoors in a dry, vibration-free environment with a low level of dust and ambient temperature of a room temperature.
- No corrosive, aggressive substances or factors permitted in the storage space (e.g. UV radiation, ozone)
- Keep the products in the original, unopened packaging before the first use.
- If temperature fluctuations or humidity in the storage space are significant, take the appropriate steps to prevent condensation.

CAUTION



Inspect the products before use for any damage that may have occurred during storage. This applies especially to plastic components (as they may become brittle).

2. General description

The pressure transmitter assembly is the control unit of the operating pressure in a centralized lubrication system.

3. Design

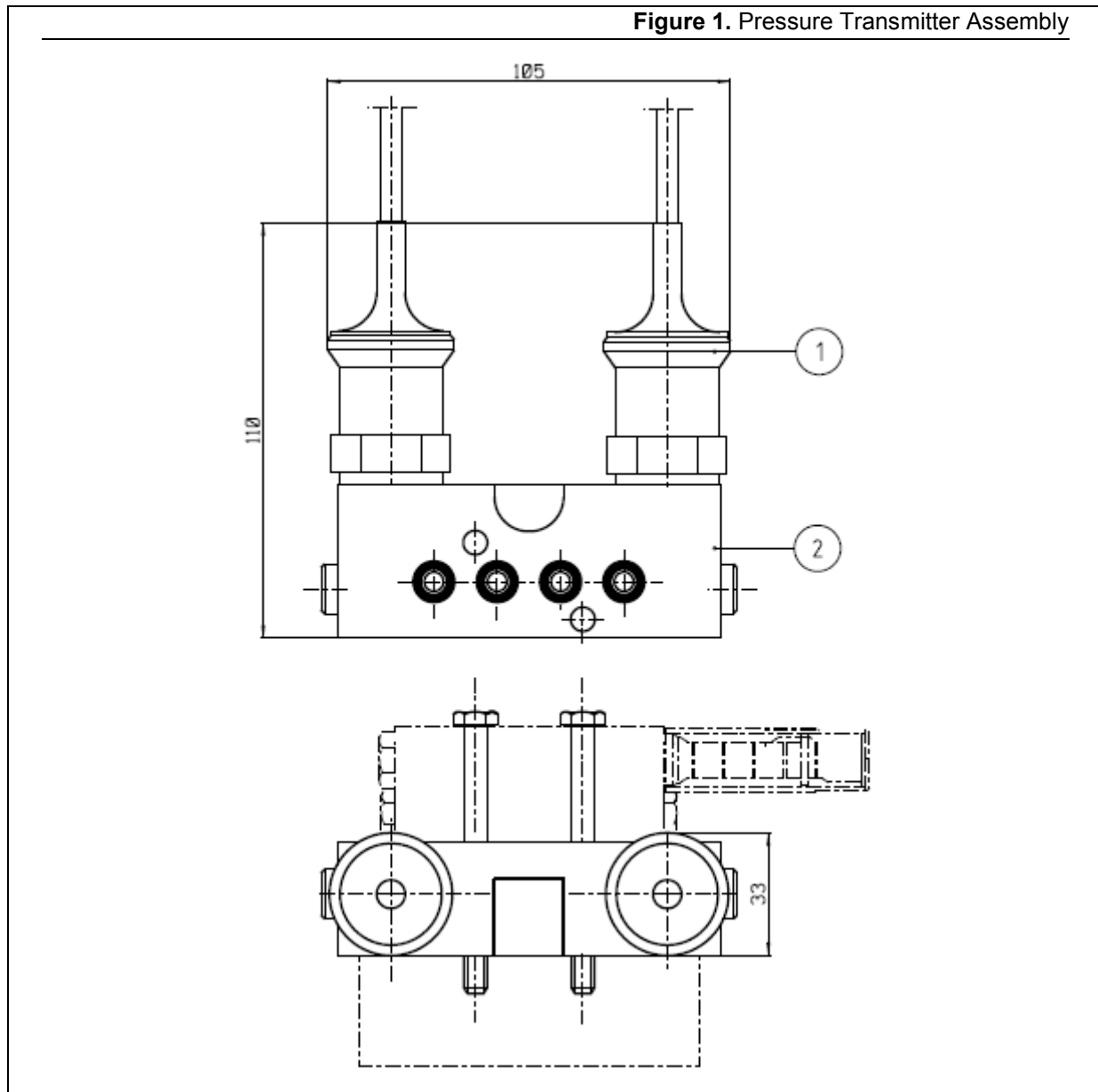

The pressure transmitter assembly is composed of a body (pos. 2) and pressure transmitters (pos.1) for both of the main lines.

4. Operation

The pressure transmitter assembly is installed on the base plate of the doser group under the doser. The pressure transmitters, which are installed in the body of the assembly, measure pressure of the passing lubricant and the information is transmitted to the control unit. The pressure of the main lines can be monitored from the control unit.

5. Settings

See SKF MAXILUBE / User interface IF-105 / Settings

See SKF ST-1240 Control Center / Settings

See SKF ST-2240-LUB Control Center / Settings

6. Technical specifications

6.1 Technical specifications of pressure transmitter

Table 1.

Quantity	Value	Unit	Description
t	-40...+85	°C	Operation temperature
p	0–250	bar	Pressure range
U	24 (10-30)	V DC	Supply voltage
I	4–20	mA	output signal of a pressure transmitter

6.2 Connections

Lubricant connections:

- Inlets: 4 pcs
- Outlets: 4 pcs

Electrical connections:

- Screened cable, length 2 m (6,5 ft)
- Inputs: supply voltage
- Outputs: output signal

6.3 Symbols

Table 2.

BPSG2-PTA-MOD-D-xx	Abbreviation	Description
BPSG:	BPSG	Base Plate SG-dosers
2:	2	2-line pressure transmitter assembly
PTA:	PTA	Pressure Transmitter Assembly
MOD:	MOD	module structure
D:	D	pressure transmitter type
xx:	ZN	body material, zinc-coated and yellow-passivated steel
	SS	body material, stainless steel AISI 316

Example:

BPSG2-PTA-MOD-D-ZN

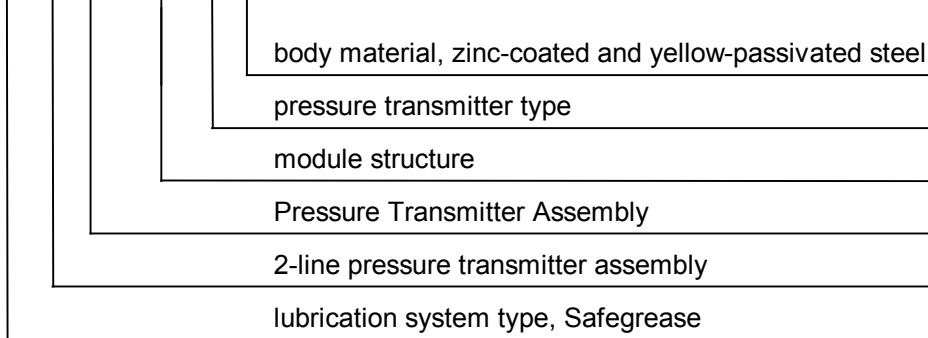
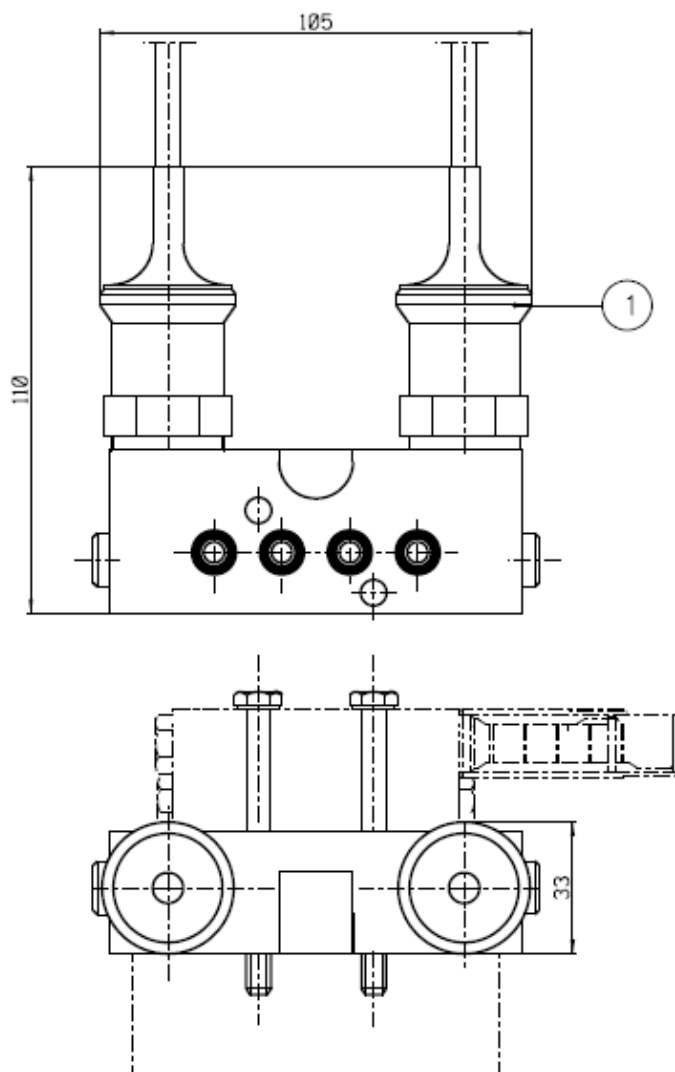

Table 3.

Type	Code
BPSG2-PTA-MOD-D-ZN	12385333
BPSG2-PTA-MOD-D-SS	12385331

7. Spare parts

Figure 2. Pressure Transmitter Spare Parts



ITEM	NAME	MATERIAL	CODE
1	Pressure Transmitter	MBS 3000	12605240

See BPSG2-PTA-MOD-D pressure transmitter assembly spare parts (drawing no. 462071).

8. Appendices, China RoHS Table

部件名称 (Part Name)	有毒害物质或元素 (Hazardous substances)					
	铅	汞	镉	六价铬	多溴联苯	多溴二苯醚
	Lead (Pb)	Mercury (Hg)	Cadmium (Cd)	Hexavalent Chromium (Cr(VI))	Polybrominated biphenyls (PBB)	Polybrominated diphenyl ethers (PBDE)
用钢和黄铜加工的零件 (Components made of machining steel and brass)	X	0	0	0	0	0
本表格依据SJ/T11364的规定编制 (This table is prepared in accordance with the provisions of SJ/T 11364.)						
0 :	表示该有毒有害物质在该部件所有均质材料中的含量均在GB/T 26572 规定的限量要求以下。 (Indicates that said hazardous substance contained in all of the homogeneous materials for this part is below the limit requirement of GB/T 26572.)					
X :	表示该有毒有害物质至少在该部件的某一均质材料中的含量超出GB/T 26572标准规定的限量要求。 (Indicates that said hazardous substance contained in at least one of the homogeneous materials used for this part is above the limit requirement of GB/T 26572.)					