

2.1 Installation of new lubricators

For installation at the application follow the steps:

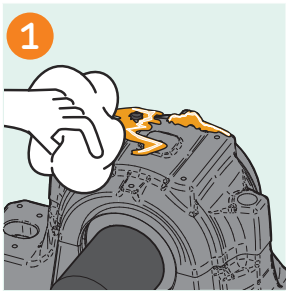

Clean the lubrication point from dirt and old grease in such a way that the dirt is not entering the lubrication point itself.

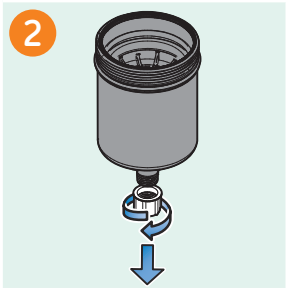

Remove the yellow protection cap from the new grease cannister.

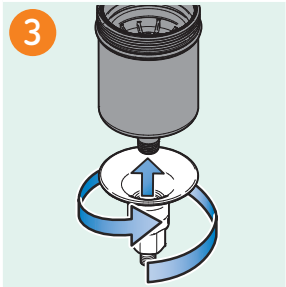

Screw the support flange on the cartridge until it is fixed.

If the support flange is mounted already on the application, don't remove it. Use sealing tape on the thread of the new cannister tip.

4

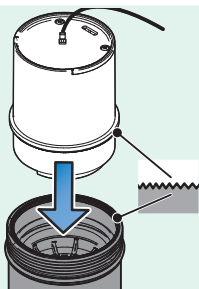

Place the drive unit on top of the full grease cannister and make sure the teeth of both parts are engaged.
The spindle head should now be inside of the motor coupler.

5

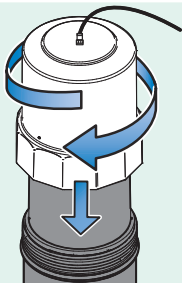

Screw the drive unit cap onto the cannister.

6

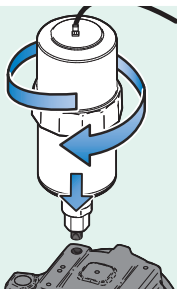

If the support flange is not mounted on the application, screw the complete lubricator onto the application. Your lubricator is ready.

If the support flange is mounted already on the application, the use of sealing tape (PTFE) on the thread of the new cannister tip is recommended.

Then screw the cartridge on the support flange mounted in the application.
Your lubricator is ready.

2.2 Replacement of canisters

In case the lubricator canister empty, the cannister should be replaced with a new full one.

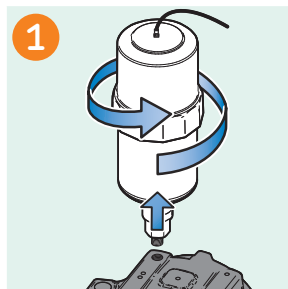

Dismount the lubricator from the application. It is recommended to keep the support flange mounted to the lubricator.

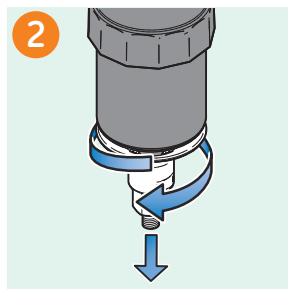

Remove the support flange from the lubricator.

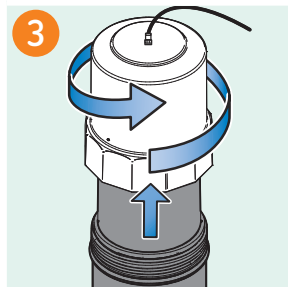

Remove the drive unit cap from the lubricator.

Continue with cleaning the lubrication point from dirt and old grease in such a way that the dirt is not entering the lubrication point itself, see paragraph → 2.1 step 1.

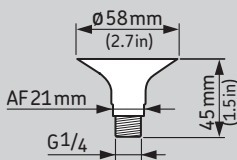
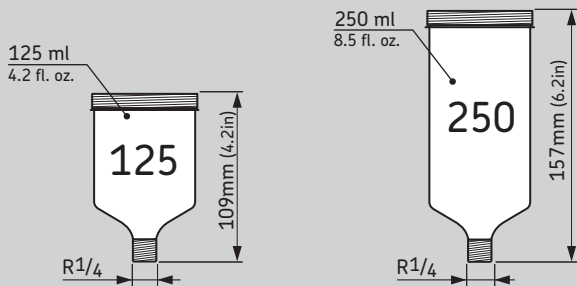
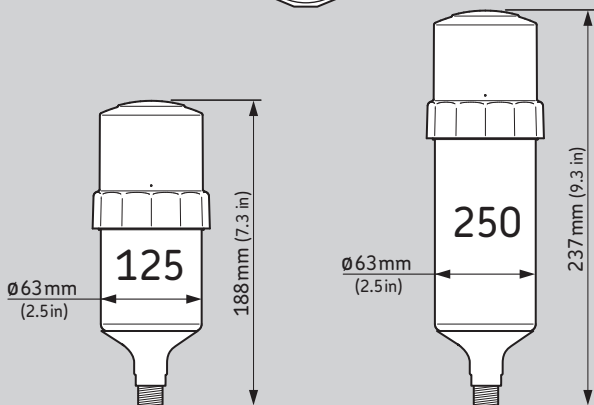
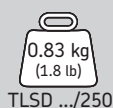
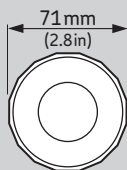
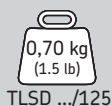



**Max.
5 bar
(72 psi)**



**Max.
3 bar
(43 psi)**



**1/2/3
4/6/8
9/10/12
months**

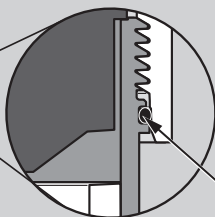

IP41



31
months

125

250

	0 ml/day	0 ml/day
OFF	0 ml/day	0 ml/day
1M	4,1 ml/day	8,2 ml/day
2M	2,0 ml/day	4,1 ml/day
3M	1,4 ml/day	2,7 ml/day
4M	1,0 ml/day	2,0 ml/day
6M	0,7 ml/day	1,4 ml/day
8M	0,5 ml/day	1,0 ml/day
9M	0,5 ml/day	0,9 ml/day
10M	0,4 ml/day	0,8 ml/day
12M	0,3 ml/day	0,7 ml/day

Dispense rate quantity is calculated assuming continues power supply. The pause time setting depends on the machine run time.

